

FITTING YOUR AUTO TOP-UP DO's and DON'T's When used without a sump

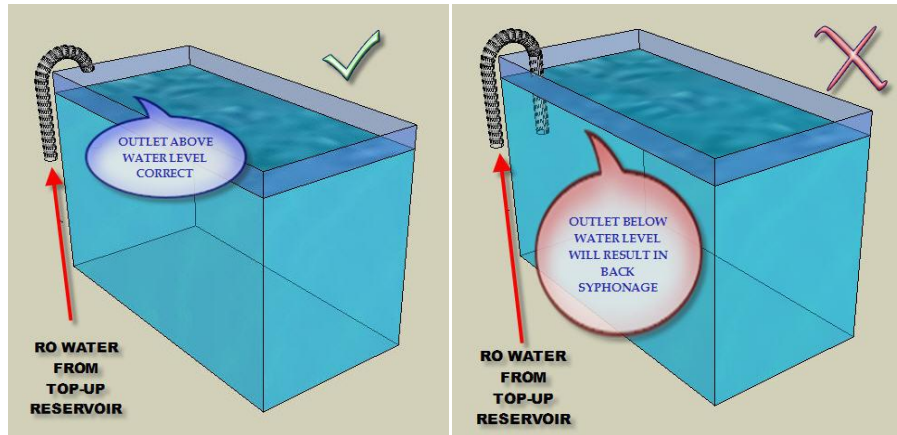

With sump

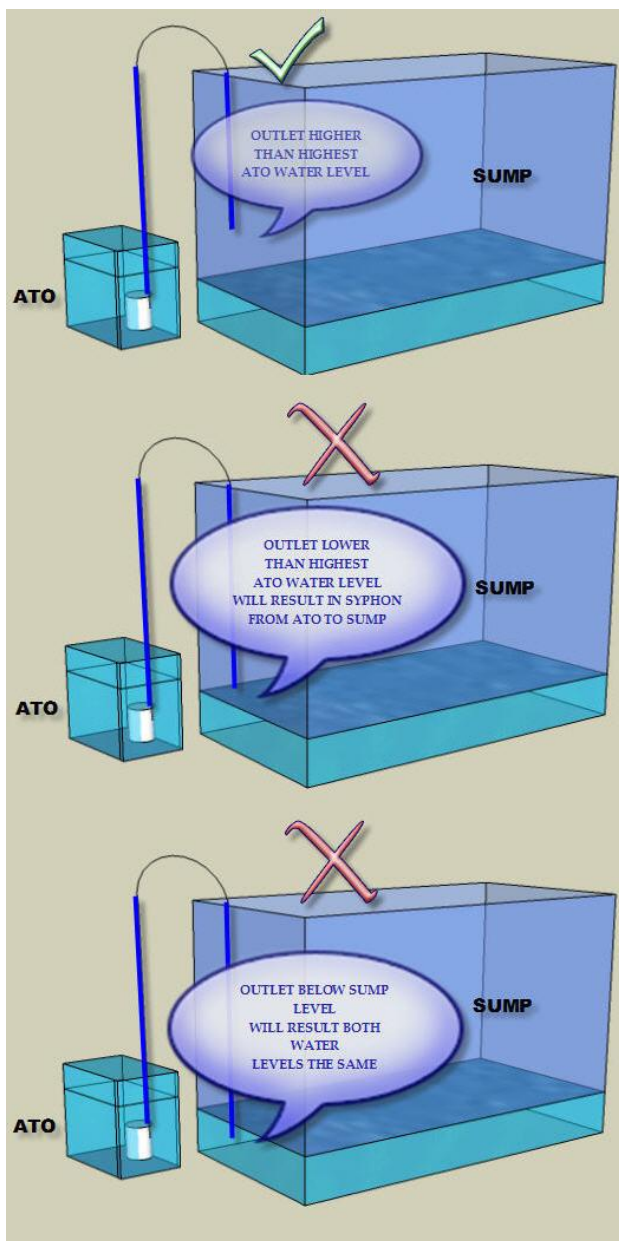

ALTHOUGH NOT ALWAYS OBVIOUS INCORRECT POSITIONING OF THE OUTLET FROM THE ATO CAN RESULT IN AN OVERFLOW SITUATION DUE TO BACK SYPHONAGE EITHER FROM THE SYSTEM OR THE ATO (AUTO TOP OFF)

THE USE OF ANTI SYPHON VALVES CAN AVOID THIS BUT ARE NOTORIOUSLY UNRELIABLE.

IF THE ABOVE GUIDE LINES ARE FOLLOWED THE SITUATION WILL NOT ARISE.

REEFLOAT.COM©

